

OPERATION:

Constant Friction Hinge guides the Swing-Up Bar up and down with less than 3 lbs. of force. The Swing-Up Bar will not move of its own weight.

ARCHITECTURAL SPECIFICATIONS

#GW-4130 SWING-UP BAR

Mounting Plate.... 10ga., 304 Stainless Steel  
Swing-Up Bar..... 1-1/4" Dia. x 18ga., 304  
Stainless Steel Tubing.  
Constant Friction Hinge... 12ga., 304 S.S.

INSTALLATION

All Swing-Up Bars must be installed using sufficient in-wall backing materials.  
A.D.A. Mounting Height is 33" to 36" above the floor level.

LOAD RATING:

GW-4130-SS Bars meet the Federal specifications of 250 lb/f (pounds of force) in a downward position.

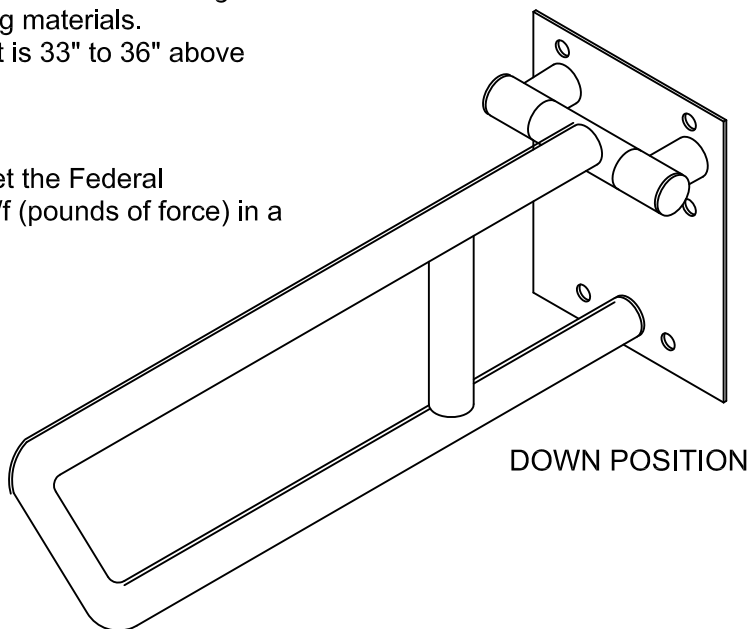

DOWN POSITION

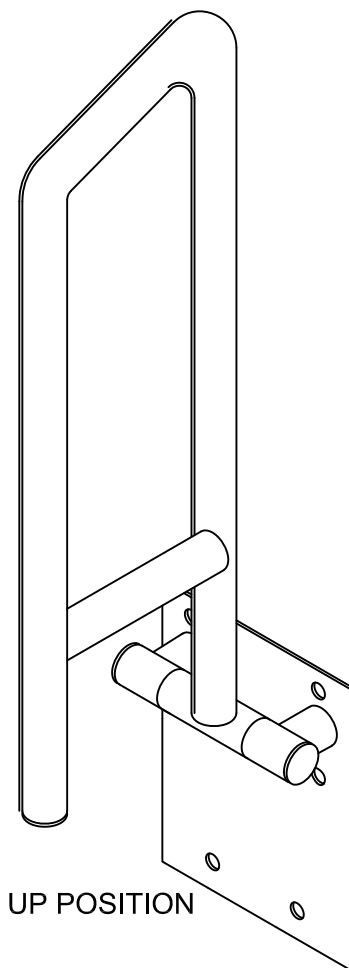

UP POSITION

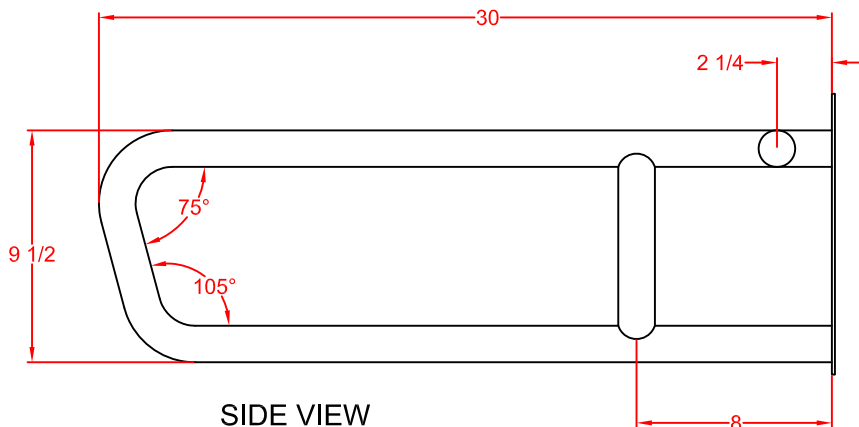

SIDE VIEW

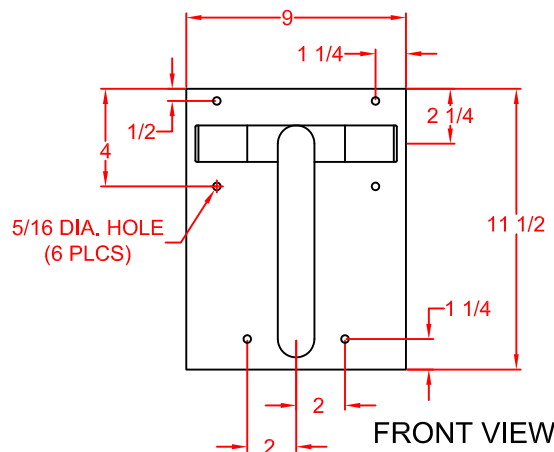

FRONT VIEW