

## Acrylic Outward Swing Door Walk-In Tub Specifications

**Actual Size:** 26" x 52" x 40" • (66.04cm x 132.08cm x 101.6cm)

**Shipping Size:** 29" x 60" x 50" • (73.66cm x 152.4cm x 127cm)

**Net Weight:** 205lbs • (92.98kg)

**Shipping Weight:** 300lbs • (136.07kg)

**Seat Width:** 19" • (48.26cm)

**Unoccupied Water Capacity:** 75gal • (283.9L)

**Occupied Water Capacity:** 35-55gal • (132.48 - 308.19L)

### Included Features (Soaking)

- 1.Acrylic shell gloss white finish fiberglass gelcoat reinforced
- 2.Stainless steel frame with adjustable leveling legs
- 3.Plastic composite and tempered glass outward swing door with 2 latch gear & shaft mechanism
- 4.Removable front apron with two access panels 5.One reversible end panel & extension panel 8"
- 6.Stainless steel chrome finish deck and wall-mounted grab bar 7.Two 2" 4-port PVC drains with 2 end caps included, 2 overflows, 2 stainless steel operated openers with extended handles in chrome finish

### Jetting & Therapy Options

- 1.Air + Hydro (LED Chromatherapy Light Included)
- 2.Hydro + Hydro Independent Foot Massage (LED Chromatherapy Light Included) \* (2)
- 3.Hydro Massage + Microbubble (LED Chromatherapy Light Included)
- 4.Hydro Massage (LED Chromatherapy Light Not Included)



## Jetting & Therapy Systems

### Hydro Massage

- Hydro Massage Pump 7A
- Intensity Dial Air Control
- Ozone Sterilization 0.04A
- 13 jets (7 Seat Jets 6 Foot Jets)
- On/Off Push Control
- In-line Water Heater 6A 650W

### Hydro + Hydro Foot Massage \*(2)

- 2 Hydro Massage Pumps 5A + 7A
- 2 Intensity Dial Air Controls
- Ozone Sterilization 0.04A
- 13 jets (7 Seat Jets 6 Foot Jets)
- On/Off Push Control
- In-Line Water Heater 6A 650W

### Air Massage •Air Massage Pump

- 4.5A 500W
- 3 Speed Pump
- Auto-purge (Activates 20 minutes after pump shutdown)
- 17 jets (11 Seat Jets 6 Foot Jets)
- On/Off push control

### Microbubble Therapy

- 1 HP Pump 7.3A
- Pressure Vessel
- On/Off push control
- Agitator Valve

### 2 Piece Faucet

- Up to 16GPM @ 60PSI (at ideal in-home plumbing conditions)
- Two 5' Water Supply Lines 3/4"
- Pull out Hand Shower in Chrome Finish with a 5' Retractable Stainless Steel Braided Hose

### Warranty

- Lifetime limited\* warranty on shell, frame, door, and parts to original purchaser/Address •Labor or installation is not covered

### Optional Features

- 1.Heated Seat and Backrest
- 2.Digital Controller

**Note:** LED Chromatherapy light 0.5A with On/Off push control is included with the following dual packages: Hydro + Air, Hydro + Micro, Hydro + Hydro

**Disclaimer\*:** AMP value for each pump may change based on availability. Please verify before purchase. (1.877.947.7769)

### Electrical Requirements

Dedicated GFCI protected electrical line(s)required 115/120V 60Hz

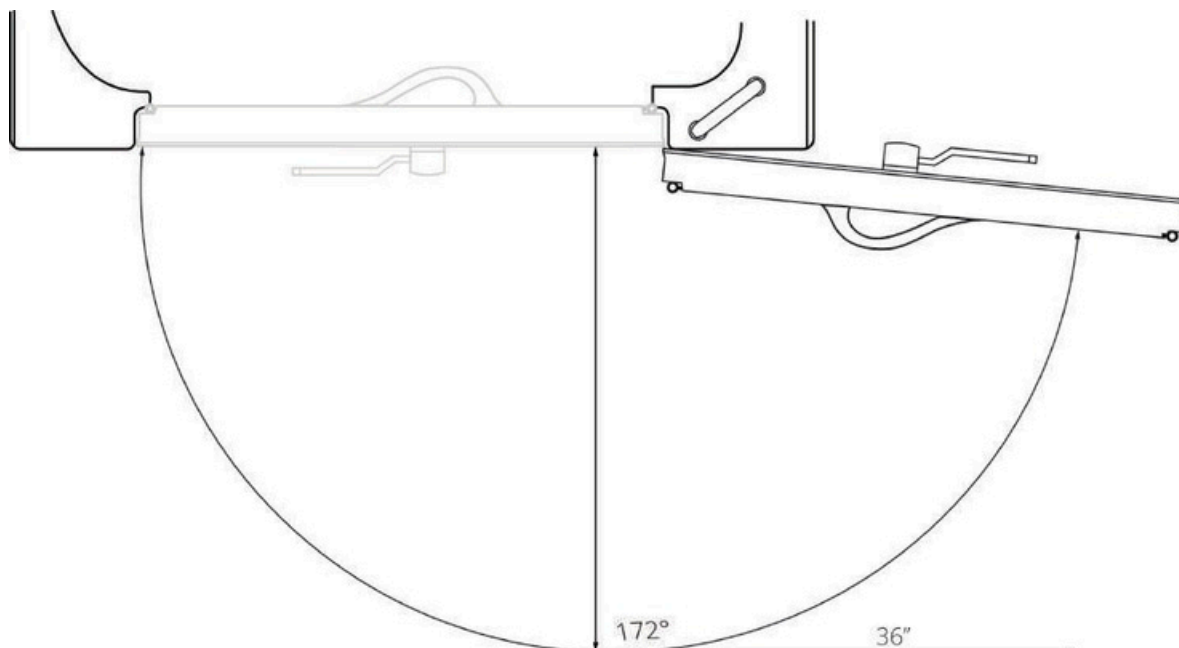



## 2" T-type Dual Port Floor Drain

### Dual Drain Technology - Two 2 Inch Independent Floor Drains

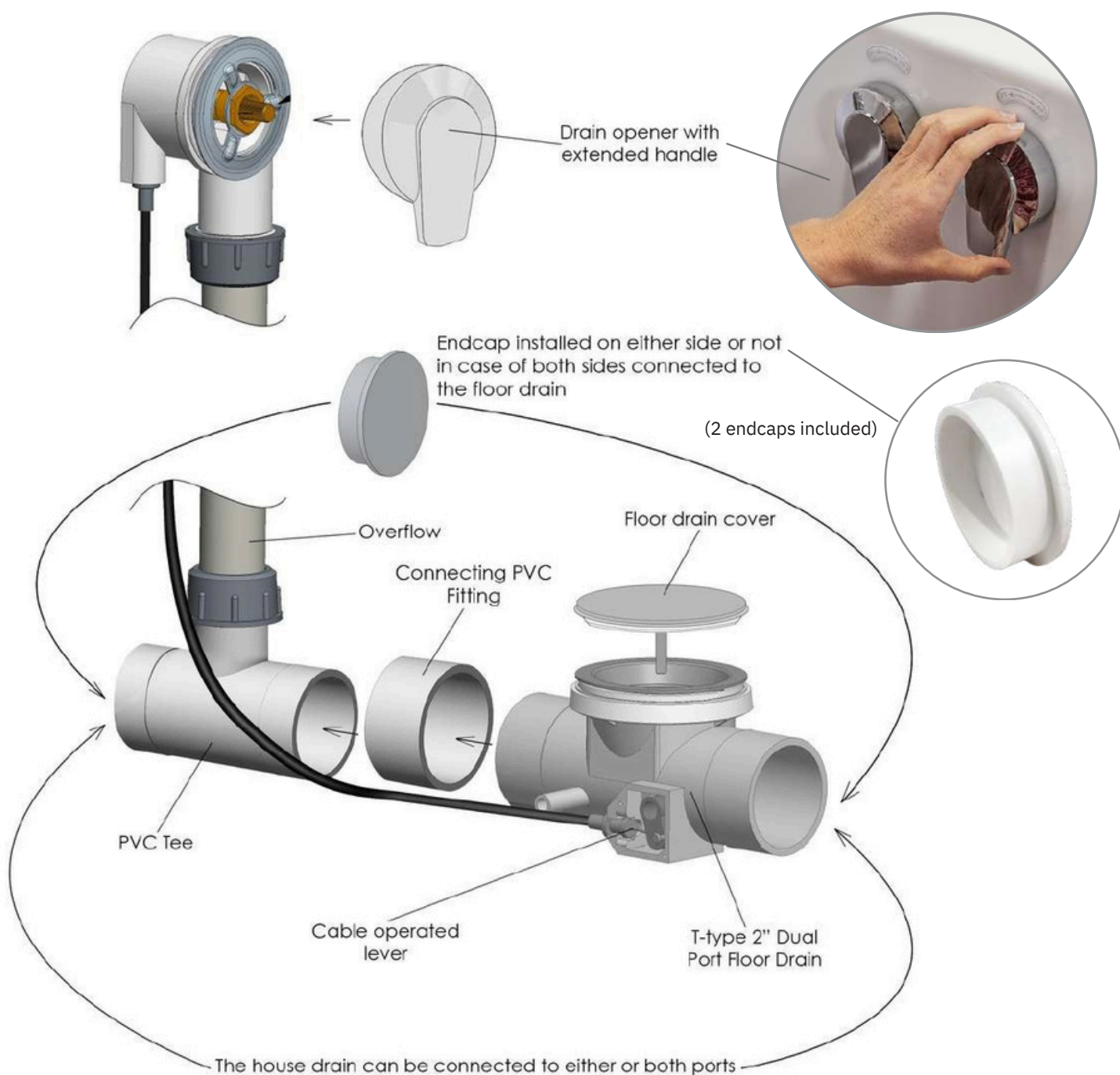



## Supply Lines, Electrical Connection, & Drain Options

### Two 3/4" connector water supply lines included with Fast Fill Faucets

Connect to Shut Off Valves (not included)



All electrical fixtures connect to a dedicated GFCI protected outlet or GFCI protected Circuit Breaker.



Images below show examples of PVC pipe connections (not included). Reducers can be used to connect smaller drain pipes.

T-Type four (4) 2" drain ports allow for the drain pipe to be installed in either direction.

Drain Caps Installed On Either Side Of The Drain unused Port.

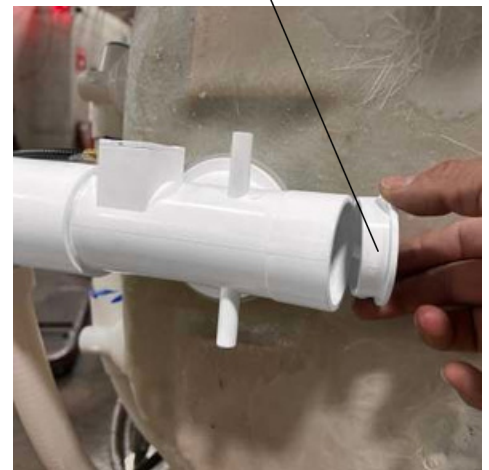

## 2 Piece Single Lever Fast-Fill Faucet

### Description

Solid brass spout in a chrome finish with a 5-setting pull out hand shower mixer with back-flow prevention valve this includes a 5' braided hose. Two 3/4" 5' braided stainless-steel supply lines are included along with Cold/Hot levers with a diverter for the hand mixer Flow

- Hand shower is limited to 1.9 GPM (7.5L/min)
- Faucet fill rate designed for 16 GPM (68.1L/min)

### Cartridge

- 40mm high flow cartridge design
- Nonmetallic/nonferrous and stainless-steel material

### Standards

- Third party certified to meet: CSA B125.1, ASMEA112.18.1, ICC117.1 and all applicable requirements referenced therein
- Certified to ANSI/NSF 61/9
- ADA for lever/handle
- IAPMO R&T UPC certified



NOTE: This faucet is designed to be installed through 2-1/2" diameter hole for faucet, 1/3" diameter hole for mounting rods, and a 7/8" diagonal hole for the hand shower.

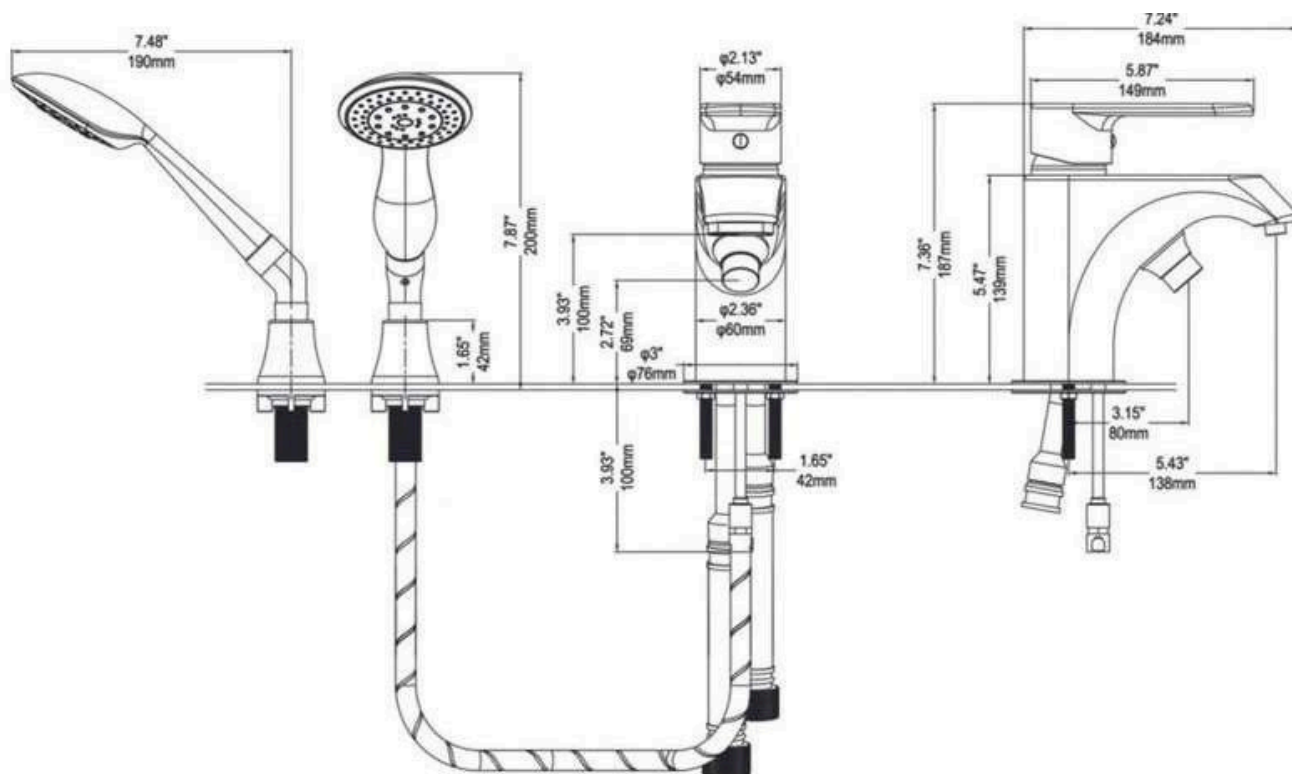

Step-by-step Instructions to replace a valve cartridge for  
Freedom 2-piece faucets.

Step.1 Remove  
the Hot/Cold  
screw hole  
cover.

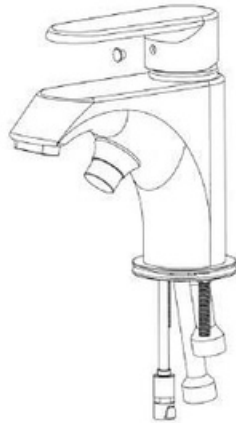

Step.2 Use an  
Allen wrench to  
remove the  
handle Screw.



Step.3 Take out  
the handle and  
remove the  
brass  
escutcheon



Step.4 Use a  
wrench to  
unscrew the  
pressure cap.



Step.5 Remove  
the cartridge  
and replace it  
with new piece.

