

TECHNICAL SPECIFICATIONS

APFXST6232LDCOL

With Seat

Interior: 60 x 30 x 76 3/4

Exterior: 66 x 32 1/8 x 78 3/4

inches

ADA/ANSI compliant when fully equipped and installed according to guidelines.

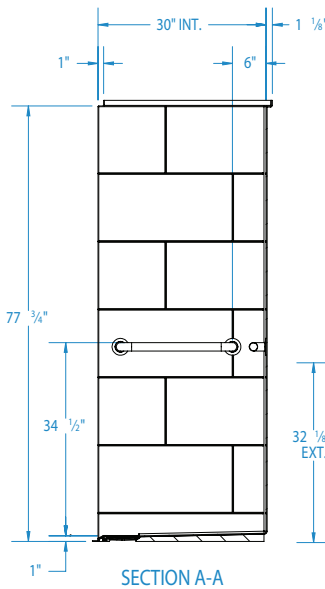
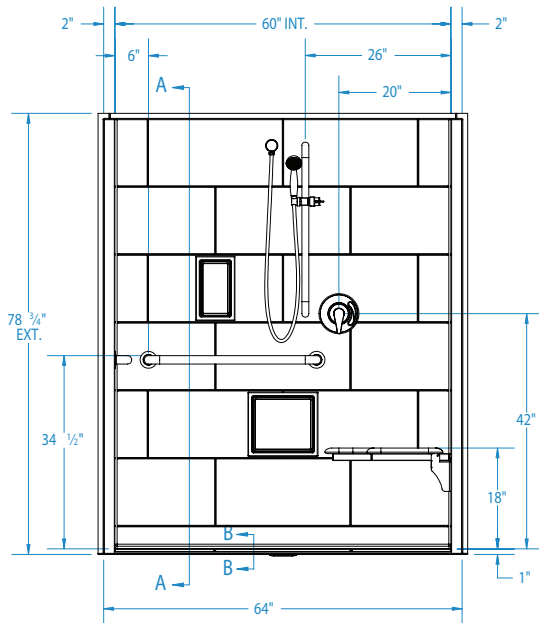

SECTION A-A

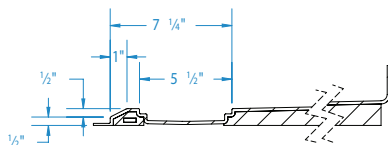
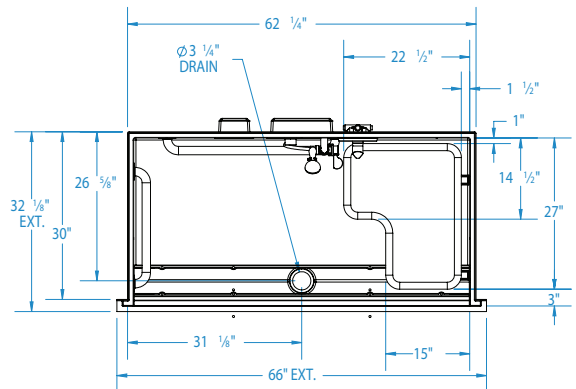

SECTION B-B
(Trench grate (Included) not shown)

Shown with available seat, grab bars, soap dishes and plumbing fixtures

FEATURES lbs Dimensional Tolerance $\pm \frac{3}{8}$ ". Dimensions needed for site preparation should be measured from the unit. Manufacturer assumes no responsibility for preparatory work.

Type and Model #	Material	Wall Finish	Pieces	Drain	Dam/Skirt Height	Net Wt.	Pkg. Wt.
Shower XST6232TR COL	applied acrylic	Smooth tile	1	Center Front	1/2" skirt 1/2" exterior COL threshold	200	210

DIMENSIONS

Specifications	inches
Width: Ext. / Int.	66 / 60
Depth: Ext. / Int.	32 1/8 / 30
Height: Ext. / Int.	78 3/4 / 76 3/4
Enclosure Opening:	60
Skirt Height:	1/2
Drain Rough-In (from Back Wall)	26 5/8
Drain Rough-In (from Side Wall)	31 1/8

FRAMING DIMENSIONS

Type	D Depth	W Width	H Height	A	B	C
Alcove	30	62 1/4	-	Box Out	31 1/8	26 5/8

