

TECHNICAL SPECIFICATIONS

APFXST6238LD1.125

Interior: 60 x 36 x 76 ¾
Exterior: 66 x 38 ⅞ x 78 ¾
inches

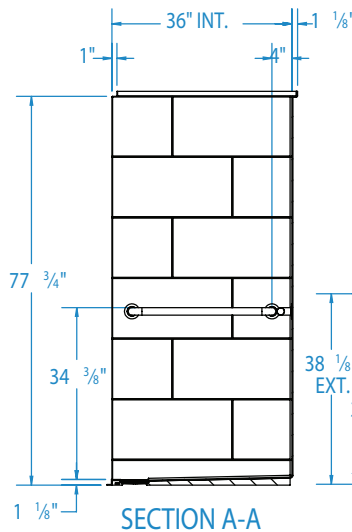
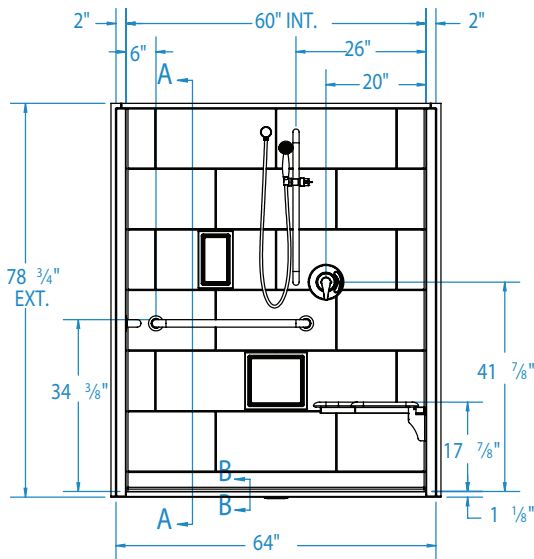

ADA/ANSI compliant when fully equipped and installed according to guidelines.

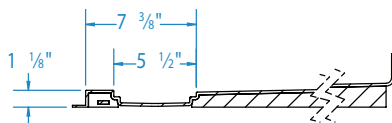
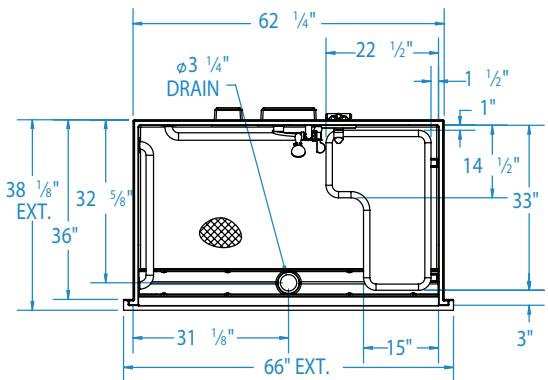

SECTION B-B
(Trench grate (Included) not shown)

Shown with available seat, grab bars, soap dishes and plumbing fixtures

FEATURES lbs Dimensional Tolerance $\pm \frac{3}{8}$ ". Dimensions needed for site preparation should be measured from the unit. Manufacturer assumes no responsibility for preparatory work.

Type and Model #	Material	Wall Finish	Pieces	Drain	Dam/Skirt Height	Net Wt.	Pkg. Wt.
Shower XST6238TR 1.125	applied acrylic	Smooth tile	1	Center Front	1 ½ skirt	200	210

DIMENSION S

Specifications	inches
Width: Ext. / Int.	66 / 60
Depth: Ext. / Int.	38 ⅞ / 36
Height: Ext. / Int.	78 ¾ / 76 ¾
Enclosure Opening:	60
Skirt Height:	½
Drain Rough-In (from Back Wall)	32 ⅝
Drain Rough-In (from Side Wall)	31 ⅞

FRAMING DIMENSIONS inches (mm)

Type	D Depth	W Width	H Height	A	B	C
Alcove	36	62 ¼	-	Box Out	31 ⅞	32 ⅝

