

INSTALLATION INSTRUCTIONS - APFHHGBLS



Includes:

- 1 - P/N HS2462CP - HandShower, on/off button, chrome finish
- 1 - P/N F14SS60 - Shower Hose, 60" Stainless Steel
- 1 - P/N SEA-SB30-TW-125-SA - 30" Grab Bar, 1.25" outer diameter, Stainless Steel with Satin Finish
- 1 - P/N 4993 - Vacuum Breaker, Brass
- 1 - P/N BBS1250x28 - Supply Elbow with EPDM gasket
- 1 - P/N Slider02-CH Chrome Slide Mechanism
- 1 - P/N NEOPERL 1.8 GPM Flow Restrictor

1. **IMPORTANT:** Have the Grab Bar connected to the wall by a licensed professional.



2. Connect the Slide Bar Bracket to the Grab Bar. See detailed photo instructions if needed.

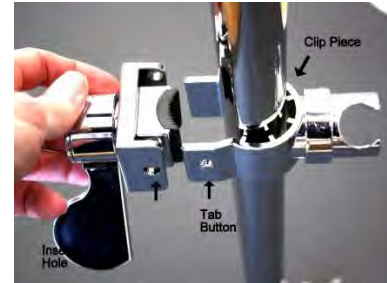

3. The connection to the water output pipe or pipe fitting should protrude 10mm-15mm from the shower wall. This connection needs to be wrapped with plumbers tape to insure a tight seal. Screw the elbow to the water pipe
4. Connect the vacuum breaker to the supply elbow.



5. Connect the Hose to the Vacuum Breaker as shown. Make sure the rubber washer is placed inside the hose connection.

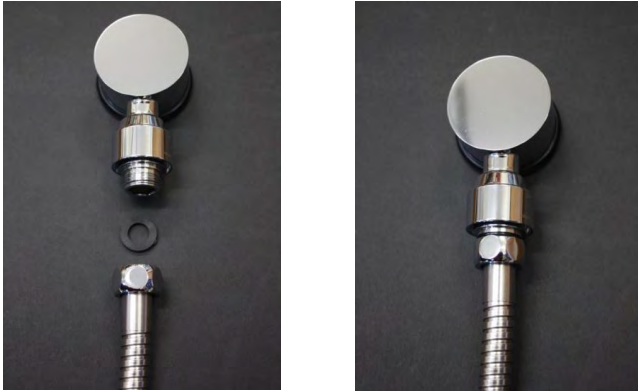

6. Connect the Hand Shower to the other end of the hose as shown. Make sure the rubber washer is placed inside the hose connection if the project does not require flow restriction to 1.8 GPM.

If the installation is in California or other location requiring 1.8 GPM max flow, insert the NEOPERL 1.8 flow restrictor into end of hand shower in place of the rubber washer. Flow restrictor should be inserted blades first so that the green plastic screen is facing outward, as shown below.

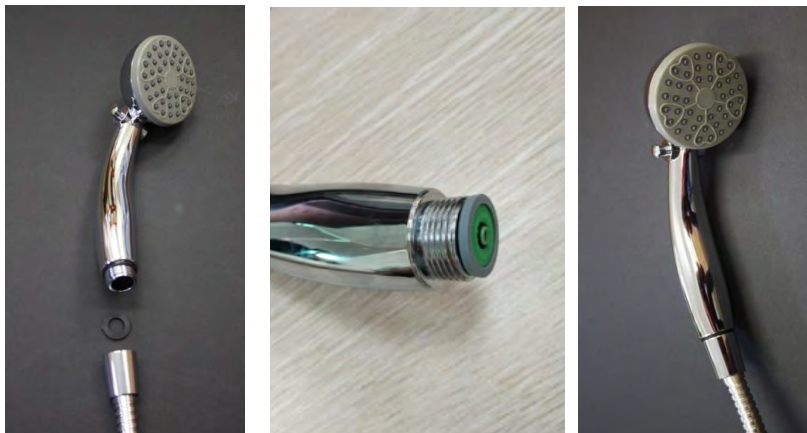

Rubber Gasket
insert

Shown with Flow
Restrictor inserted

Shown with Hose
Attached

Installing the sliding shower holder

Lever: Moves to loosen and tighten the connection with a Grab Bar in order to slide the attachment up & down.

Clip: Slides over the Grab Bar.

Clip for holding the Handheld Shower

Tab Buttons & Insertion Hole: The tabs click into the insertion holes, locking the two pieces together. The two pieces are locked together in the photo shown below.

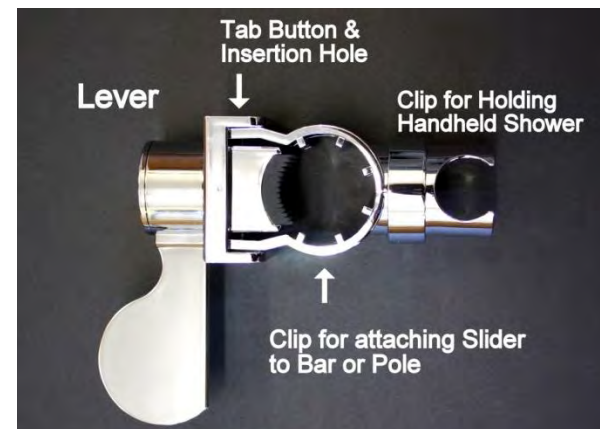

Step 1

Separate the clip piece from the lever piece by depressing both sides of the clip piece at the same time so the tab buttons will come free of the insertion holes.

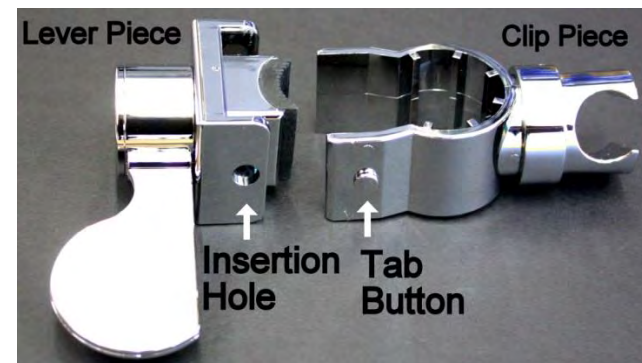

Step 2

Push the arms of the Clip Piece around the Grab Bar.

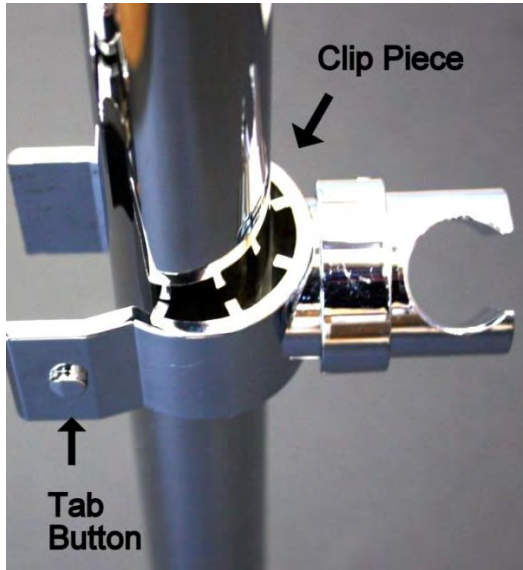

Step 3

The clip piece should fit snugly around the Grab Bar.

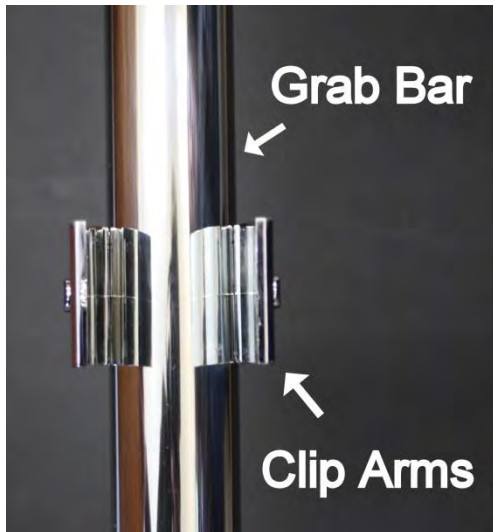

Step 4

Attach the lever piece by sliding until the tabs lock into the holes. This will lock the two pieces into place around the Grab Bar.

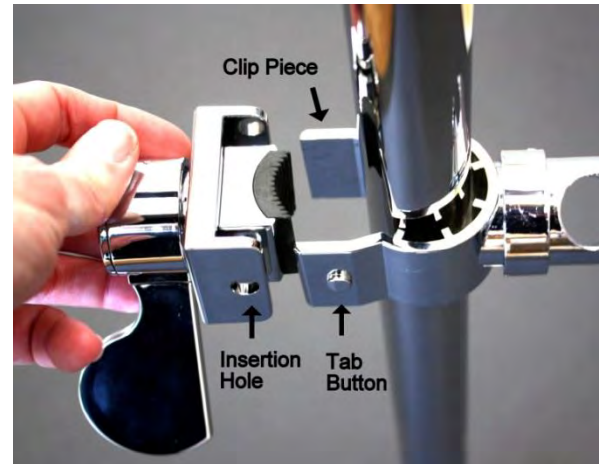

Step 5

When the Lever is in the up position, the two piece assembly will slide up or down the Grab Bar allowing the shower to be located at the most comfortable height. Push the lever down to lock the shower into place.

