

# Outward Swing Door Walk-In Tub Specifications

**Actual Size:** 26" x 45" x 39" • (66.04cm x 114.3cm x 99.06cm)

**Shipping Size:** 28" x 48" x 49" • (71cm x 122cm x 124cm)

**Net Weight:** 210lbs • (95.3kg)

**Shipping Weight:** 280 lbs • (127kg)

**Seat Width:** 19" • (48.26cm)

**Unoccupied Water Capacity:** 75gal • (284L)

**Occupied Water Capacity:** 35-55gal • (125 - 208L)

## Included Features (Soaking)

1. Acrylic shell gloss white finish fiberglass gelcoat reinforced
2. Stainless steel frame with adjustable leveling legs
3. Custom crafted industrial plastic composite outward swing door with tempered glass
4. Removable front apron with two access panels (seat side)
5. One reversible end panel for left or right corner installation options
6. Stainless steel chrome finish U-shape wall-mounted grab bar
7. Single 2" Drain with an emergency pull up chain, consisting of two 2" outlets and an overflow

## Jetting & Therapy Option

1. Hydro Massage (LED Chromatherapy Light Not Included)



## Jetting & Therapy Systems

### Hydro Massage

- Hydro Massage Pump 7A
- Intensity Dial Air Control
- Ozone Sterilization 0.04A
- 15 jets (9 Seat Jets 6 Foot Jets)
- On/Off Push Control
- In-line Water Heater 6A 650W

### Electrical Requirements

Dedicated GFCI protected electrical line(s) required 110/120V 60Hz

### 2 Piece Faucet

- Up to 16GPM @ 60PSI (at ideal in-home plumbing conditions)
- Two 5' Water Supply Lines 3/4"
- Pull out Hand Shower in Chrome Finish with a 5' Retractable Stainless Steel Braided Hose

### Optional Features

Heated Seat and Backrest

### Disclaimer\*:

AMP value for each pump may change based on availability.

### Warranty

- Lifetime limited\* warranty on shell, frame, door, and parts to original purchaser/Address
- Labor or installation is not covered

Acrylic Outward Swing Door Walk-In Bath Specifications

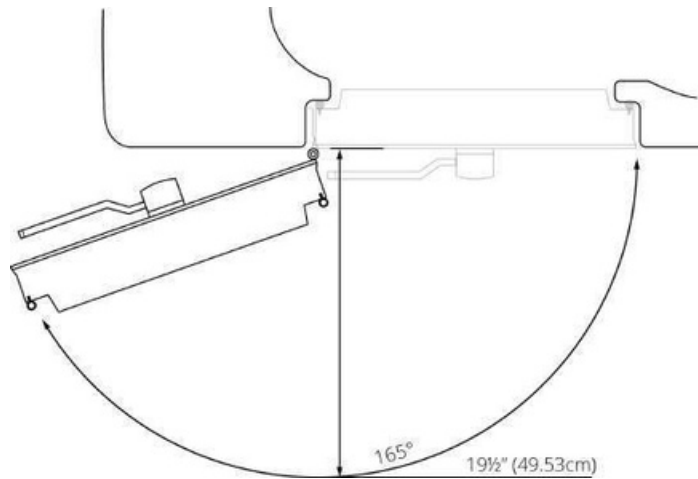
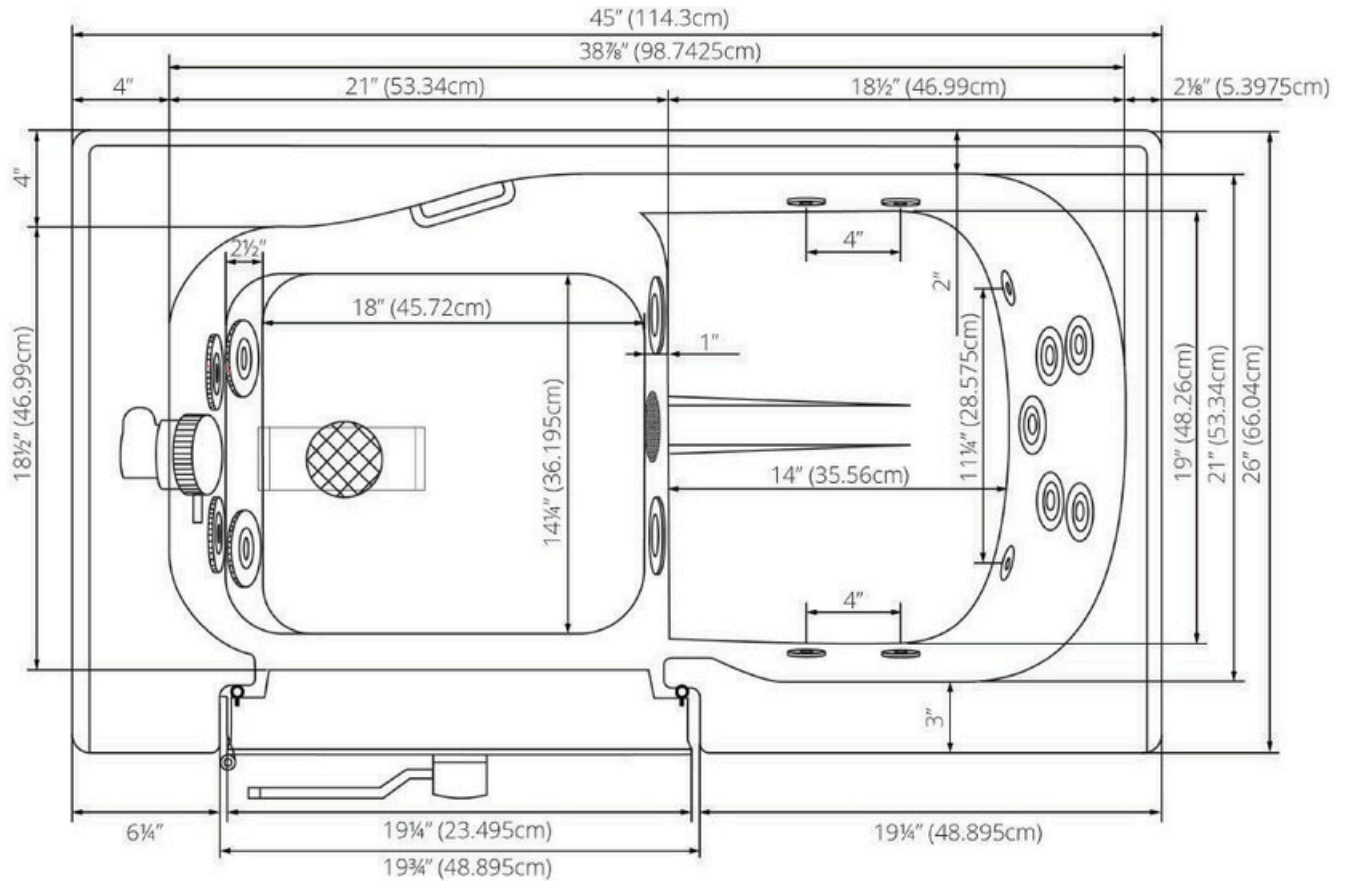

Acrylic Outward Swing Door Walk-In Tub Specifications

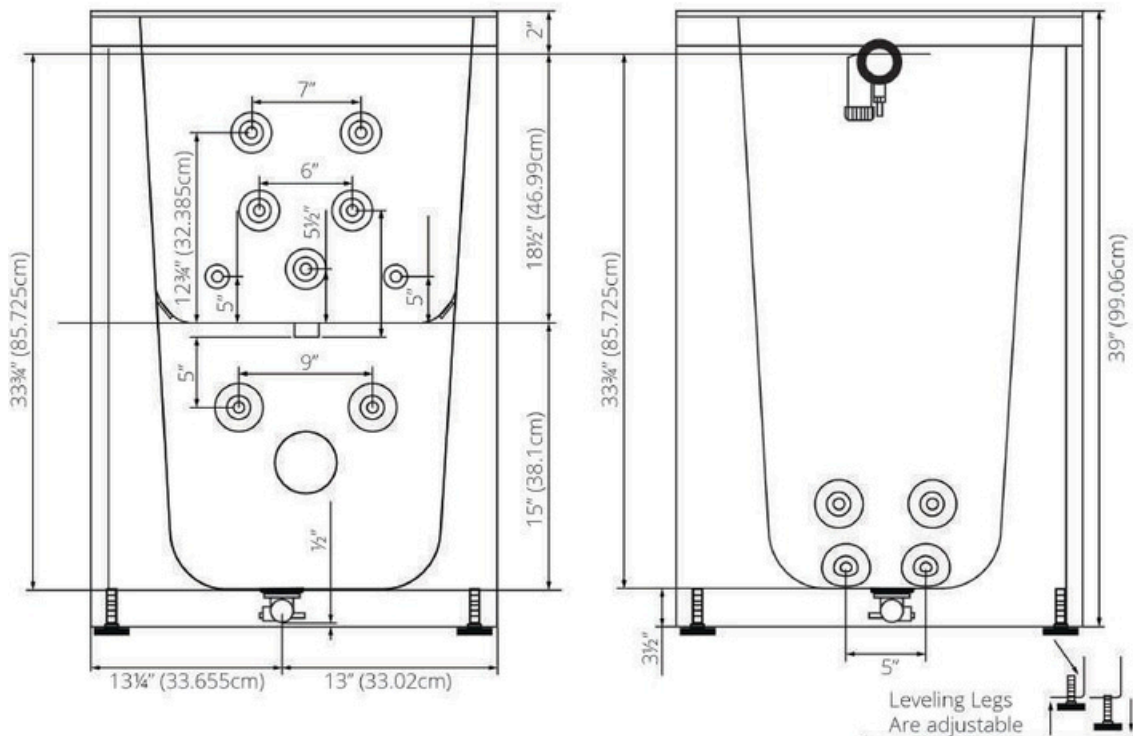
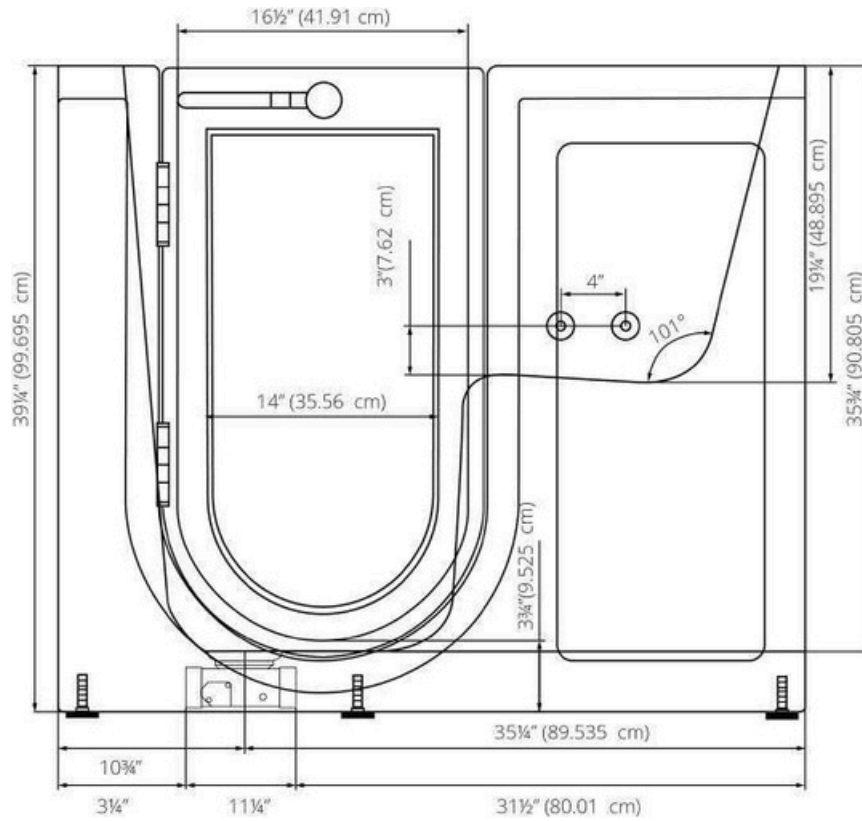

# T-Type Single Port Floor Drain (1 Drain Included)

2" T-type Dual Port Floor Drain for  
Dual Drain Walk-In Bathtubs

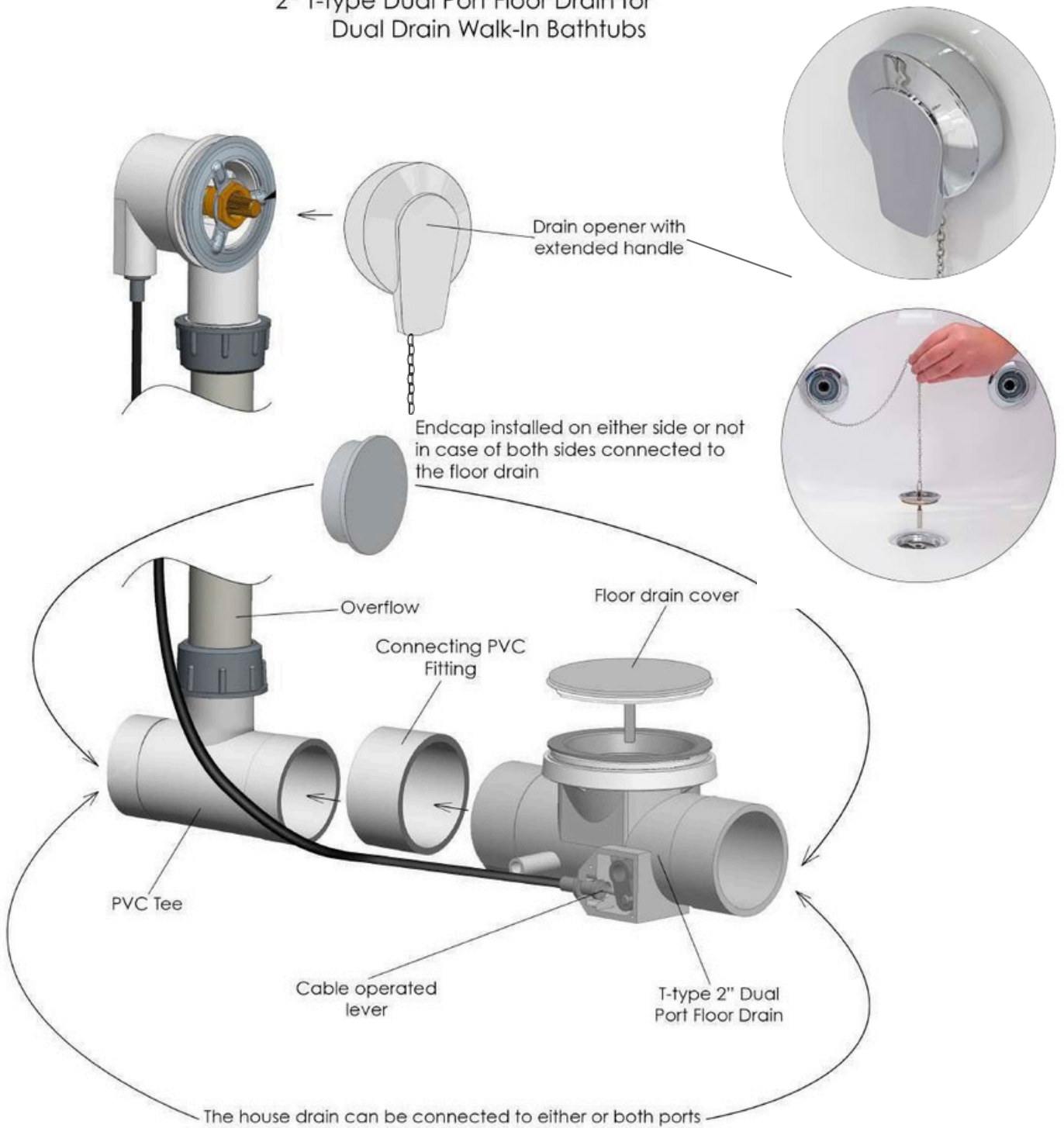

Supply Lines, Electrical Connection, & Drain Options

Two 3/4" connector water supply lines included with Fast Fill Faucets  
Connect to Shut Off Valves (not included)



All electrical fixtures connect to a dedicated GFCI protected outlet or GFCI protected Circuit Breaker.



Images below show examples of PVC pipe connections (not included). Reducers can be used to connect smaller drain pipes.

T-Type four (4) 2" drain ports allow for the drain pipe to be installed in either direction.

Drain Caps Installed On Either Side Of The Drain unused Port.

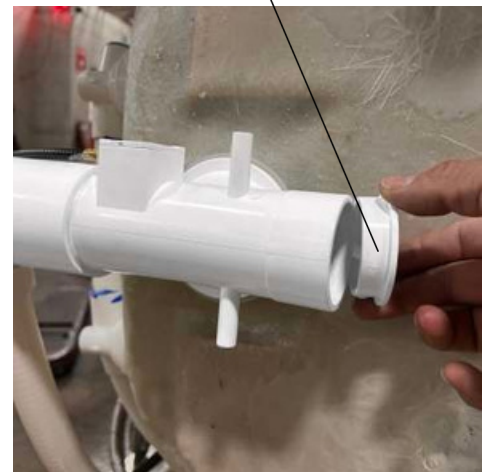



# Replacing A Valve Cartridge

Step-by-step Instructions to replace a valve cartridge for Freedom 2-piece faucets.

Step.1 Remove the Hot/Cold screw hole cover.

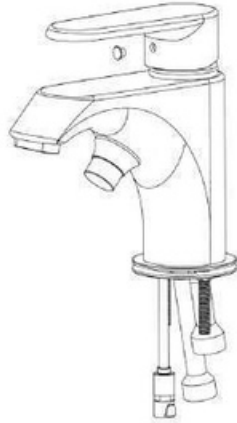

Step.2 Use an Allen wrench to remove the handle Screw.



Step.3 Take out the handle and remove the brass escutcheon



Step.4 Use a wrench to unscrew the pressure cap.



Step.5 Remove the cartridge and replace it with new piece.

